

---

# MC111M & MC111DM INTERCOM SYSTEM

## OWNER'S GUIDE

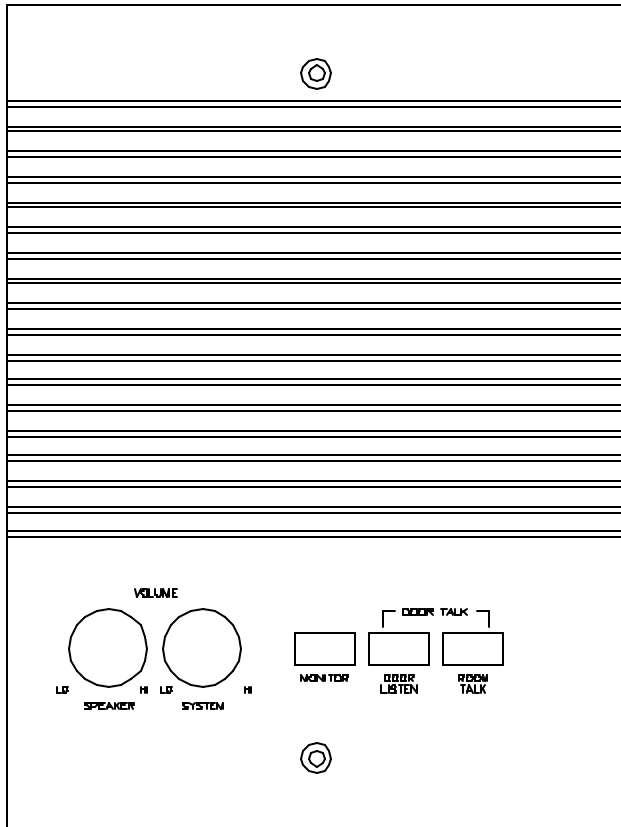

---

This booklet contains the information you need to get the most enjoyment from your MC111M or MC111DM intercom as well as important warranty information. Retain this booklet for future reference.

---

## CONTENTS

ABOUT YOUR SYSTEM .....	2
MASTER UNIT CONTROLS AND FEATURES .....	3
REMOTE STATION CONTROLS AND FEATURES .....	4
REMOTE STATION with MONITOR - CONTROLS AND FEATURES .....	5
SETTING UP YOUR SYSTEM .....	6
OPERATING YOUR SYSTEM .....	7
TROUBLESHOOTING TIPS .....	8
WARRANTY .....	9

NOTE: Product specifications are subject to change without notice

Copyright © 2000 by M&S Systems

---

## ABOUT YOUR SYSTEM

The MC111M or MC111DM from M&S Systems is a complete home communications system that includes these outstanding features:

Convenient room-to-room communication throughout your home.

Safely answer your front door from any room in the house.

A high quality built-in 3-note door chime that can be used on one or two doors. The second door will sound only one note for easy identification between the two doors.

Room monitoring that helps you keep watch over your baby or small child.

Music distribution that allows any music source to be played over the intercom speakers throughout your home.

A door release function is available on the MC111DM.

Like all M&S Systems products, the MC111M or MC111DM Master Units is designed to make your home atmosphere safe and enjoyable. M&S Systems is committed to producing high quality products for your home. If you have any questions about the operation of your system, please call us at 1-800-366-9422.

---

## MASTER UNIT CONTROLS AND FEATURES

The illustration below shows the controls and features used to operate the MC111M or MC111DM Master Units.

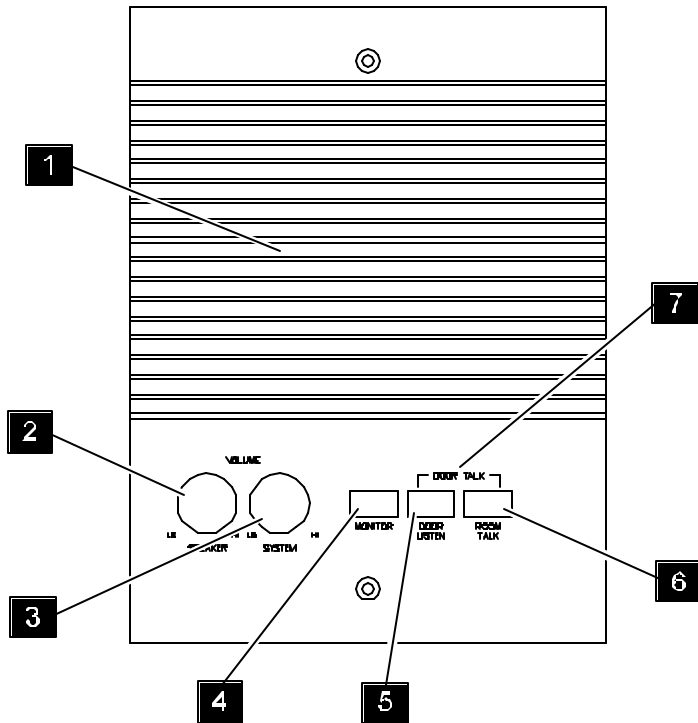

1. Speaker/Microphone
2. Speaker Volume
3. System Volume
4. Monitor Switch (Door Release on MC111DM)

5. Door Listen Switch
6. Room Talk Switch
7. Door Talk (Press both buttons)

---

## REMOTE STATION CONTROLS AND FEATURES

The illustration below shows the controls and features used to operate the N35 or N35D remote station models.

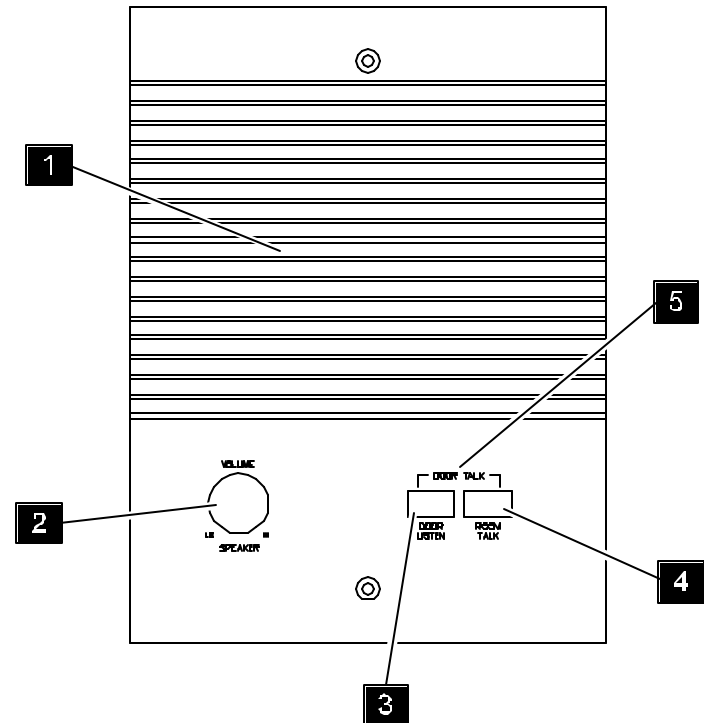

1. Speaker/Microphone
2. Speaker Volume (Door Release N35D only)
3. Door listen
4. Room talk
5. Door talk (Press both buttons)

## REMOTE STATION with MONITOR - CONTROLS AND FEATURES

The illustration below shows the controls and features used to operate the N14 remote station model.

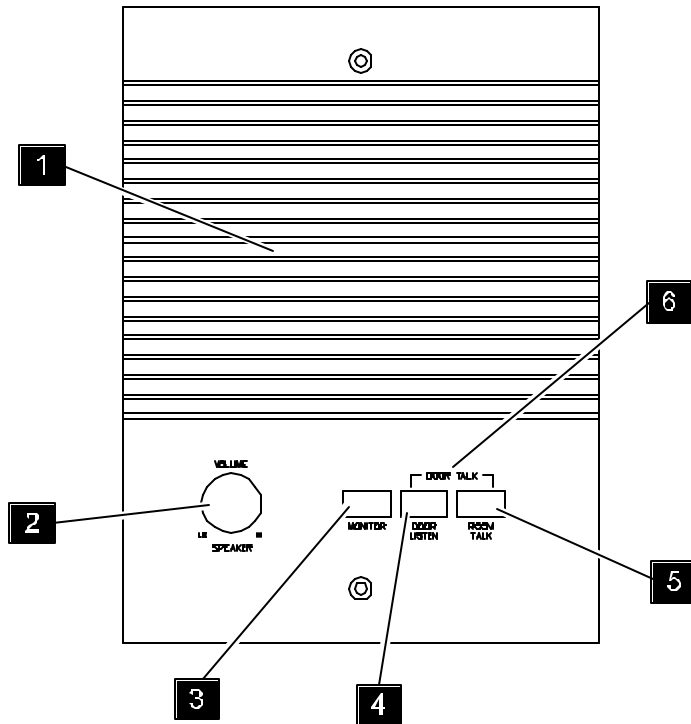

1. Speaker/Microphone
2. Speaker Volume
3. Monitor
4. Door listen
5. Room talk
6. Door talk (Press both buttons)

## SETTING UP YOUR SYSTEM

**System Volume Control** - This control is located only on the master speaker. The normal range is between 12 and 1 o'clock.

**Speaker Volume Control** - The normal setting for speaker volume control knobs is the maximum clockwise position. Speaker volume controls should only be turned down to make a particular room quieter than others.

**Chime Volume** - Chime volume was set during installation but may be changed if necessary. Before changing the chime volume, be sure all speaker volume controls are at their maximum positions when you test the volume level. To adjust the chime volume, remove the master speaker from the wall and turn the chime volume control on the back with a small flat-bladed screwdriver.

**Music Volume** - Music volume can be controlled by the system volume control. However, the system volume control also affects the intercom communications volume level. A separate volume control for the music is contained inside the master speaker. This can be adjusted for softer background music while still maintaining intercom communications at the desired level. Be sure all speaker volume controls are at the maximum and the system volume has been set to the desired level before adjusting the music volume. To adjust the music volume, carefully remove the monitor button (door release on MC111DM) and adjust the volume using a small flat-bladed screwdriver.

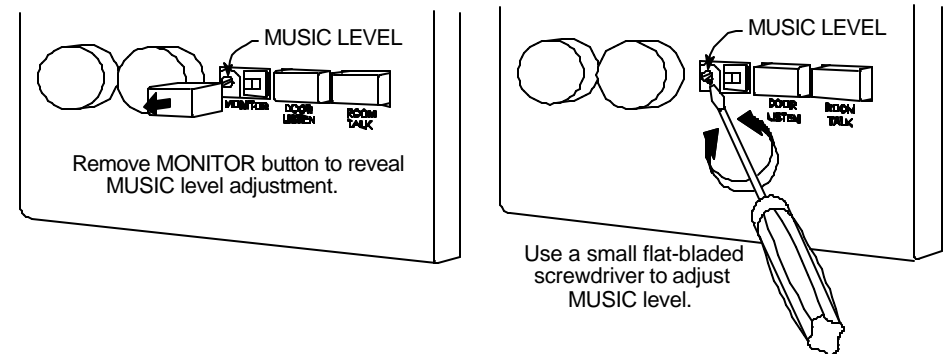

## OPERATING YOUR SYSTEM

- Room Talk** Press and hold this button to talk to other room stations, including patio speakers.
- Door Listen** Press and hold this button to listen to the door speaker(s).
- Door Talk** Press and hold both 'Room Talk' and 'Door Listen' to talk to the door speaker(s).
- Monitor** Press this locking button to monitor this station from other rooms. For example, in a baby's room, you would press the button in and be able to hear the baby at any of the other room stations. Rooms in monitor mode cannot hear any communications from other rooms.
- Door Release** On the MC111DM, Press the button labeled "Door Release". On the N35D door release speakers, press the volume control knob to perform a door release function.

## TROUBLESHOOTING TIPS

PROBLEM	WHAT TO CHECK
Chime does not ring or is not loud enough.	Speaker volume controls have been turned down.
	Check to see if speaker is in monitor mode.
	Chime volume needs to be adjusted (see Setting Up Your System).
Feedback or squeal is heard when communicating.	System volume has been set too high.
Intercom communication is not loud enough.	Speaker volume controls have been turned down.
	System volume is set too low.
Music volume is too loud or soft.	Speaker volume controls have been turned down.
	System volume is set too low.
	Music volume needs to be adjusted (see Setting Up Your System).
Can't MONITOR or MONITOR is not loud enough.	Remote station to be monitored does not have the MONITOR button pressed in.
	Speaker volume control on the monitored station is set too low.
	Speaker volume control turned down at stations to hear the monitored stations(s).
	All stations and the master are in the MONITOR position. At least one station must NOT be in the MONITOR position to be able to hear the monitored stations.

---

# WARRANTY

## M&S SYSTEMS Limited 2-Year No-Fault Product Warranty

M&S SYSTEMS warrants for 2 years all products to be free of defects (M&S SYSTEMS honors the 10-Year No-Fault warranty for AirVac Gold power units. See section below). The warranty period begins from either (1) the date of "first user" purchase of this product or (2) the first close of escrow date on a residence in which this new product was originally installed. This warranty extends to the original user of the product and to each subsequent owner of the product during the term of this warranty. M&S SYSTEMS will repair or replace, at its option, parts and materials at no charge. Parts supplied under this warranty may be new or rebuilt at the option of M&S SYSTEMS.

If, during the limited warranty period, it appears as though this product contains a defect which is covered by this limited warranty, **call our toll free service number before dismantling the product (1-800-877-6631). Remember to attain a Return Authorization Number (RAN) before returning any product to M&S SYSTEMS. Send this product freight pre-paid and insured to our service center for warranty repair.** You will be advised on shipping instructions when you call the toll free service number. M&S SYSTEMS will return the repaired product freight pre-paid within the U.S.A. The installing dealer or distributor may assist you, at your choice and expense, with returning product for repair. Please include a brief description of the problem and a dated proof-of-purchase receipt with any product that is returned for warranty repair. **ANY PRODUCT RETURNED WITHOUT A RETURN AUTHORIZATION NUMBER WILL BE REFUSED.**

**THIS LIMITED WARRANTY IS IN LIEU OF ANY OTHER WARRANTIES, EXPRESS OR IMPLIED, INCLUDING ANY IMPLIED WARRANTY OF MERCHANTABILITY OR FITNESS FOR A PARTICULAR PURPOSE OR OTHERWISE, AND OF ANY OTHER OBLIGATIONS OR LIABILITY ON THE SELLER'S PART. THIS LIMITED WARRANTY DOES NOT COVER DAMAGE CAUSED BY IMPROPER INSTALLATION, THE VIOLATION OF APPLICABLE BUILDING OR ELECTRICAL CODES, OR THE USE OF NON-M&S/NON-AIRVAC WIRE, CABLE OR WALL HOUSINGS. THIS LIMITED WARRANTY APPLIES ONLY TO PRODUCTS INSTALLED IN A PRIVATE RESIDENCE.**

**UNDER NO CIRCUMSTANCES SHALL THE SELLER BE LIABLE FOR CONSEQUENTIAL, INCIDENTAL OR SPECIAL DAMAGES ARISING IN CONNECTION WITH USE, OR INABILITY TO USE THIS PRODUCT. IN NO EVENT SHALL SELLER'S LIABILITY, FOR BREACH OF WARRANTY, BREACH OF CONTRACT, NEGLIGENCE, OR STRICT LIABILITY, EXCEED THE COST OF THE PRODUCT COVERED HEREBY. NO PERSON IS AUTHORIZED TO ASSUME FOR US ANY OTHER LIABILITY IN CONNECTION WITH THE SALE OF THIS PRODUCT.**

Some states do not allow the exclusion or limitation of consequential, incidental or special damages, so the above limitation or exclusion may not apply to you. This limited warranty gives you specific legal rights, and you may also have other rights which vary from state to state.

Please record the following information for future reference:

Installer \_\_\_\_\_

Date of installation \_\_\_\_\_

Model \_\_\_\_\_

Serial number \_\_\_\_\_

Distributed by:

  
115740 Rev A

  
7 27 066 08005 9

Printed in the U.S.A.